

HL-L5000D

? FAQs & Troubleshooting

Date: 04/12/2017 ID: faq00000154_070

Replace Drum

The Brother machine has separate consumables - the toner cartridge and the drum unit. Verify you replace only the drum unit and not the toner cartridge. If you want to know their difference, refer to "[What is the difference between the toner cartridge and the drum unit?](#)"

Replace the drum following the steps below:

- [Replacing the drum unit](#)
- [Reset the drum counter](#)

Replacing the drum unit

1. Make sure that the machine is turned on.
2. Open the front cover.

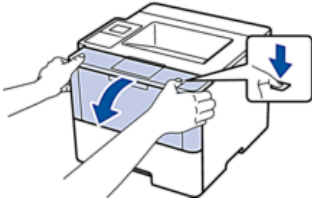

3. Remove the toner cartridge and drum unit assembly from the machine.

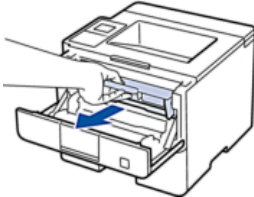

4. Push down the green lock lever and take the toner cartridge out of the drum unit.

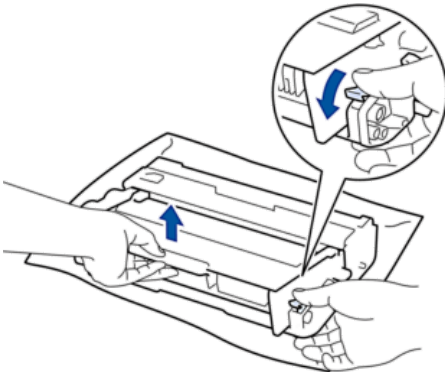

5. Unpack the new drum unit.

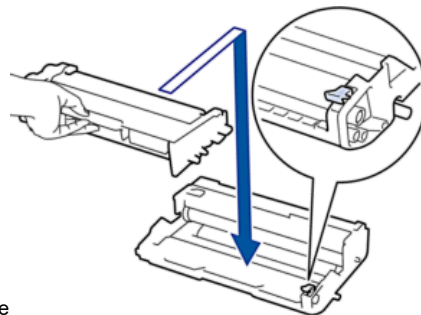

6. Put the toner cartridge firmly into the new drum unit until you hear it lock into place

This website is using cookies. By continuing to browse, you are accepting our legal notice.

7. Clean the corona wire inside the drum unit by gently sliding the green tab from left to right and right to left several times.

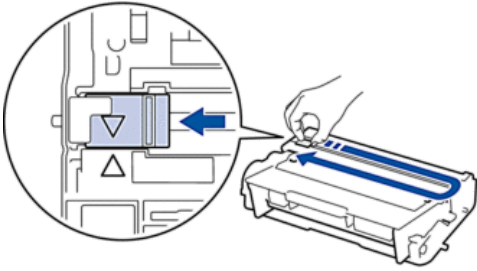

Be sure to return the tab to the Home position (▲). The arrow on the tab must be aligned with the arrow on the drum unit. If it is not, printed pages may have a vertical stripe.

8. Install the toner cartridge and drum unit assembly back into the machine.

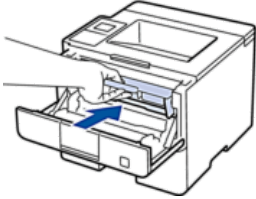

9. Close the front cover of the machine.

Reset the drum counter

When you replace the drum unit with a new one, you need to reset the drum counter by completing the following steps:

1. Make sure the machine is **turned on**.
2. Open the front cover.

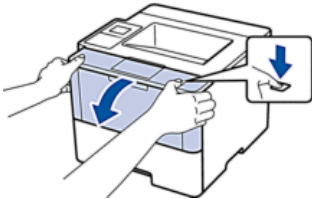

3. Press and hold **OK** for about two seconds to display **Drum Unit**, and then press **OK**.
4. Press the **Up** arrow key to reset the drum counter.
5. Close the front cover of the machine.

If your question was not answered, have you checked other FAQs?

[Go to the Top page in the FAQs & Troubleshooting section](#)

[See other FAQs in this category](#)

Have you checked the manuals?

[Go to the Manuals section](#)

If you need further assistance, please contact Brother customer service:

[Go to the Contact Us section](#)

Related Models

HL-L5000D, HL-L5050DN, HL-L5100DN(T), HL-L5200DW(T), HL-L6250DN

Content Feedback

This website is using cookies. By continuing to browse, you are accepting our legal notice.